

# Spacers & Accessories

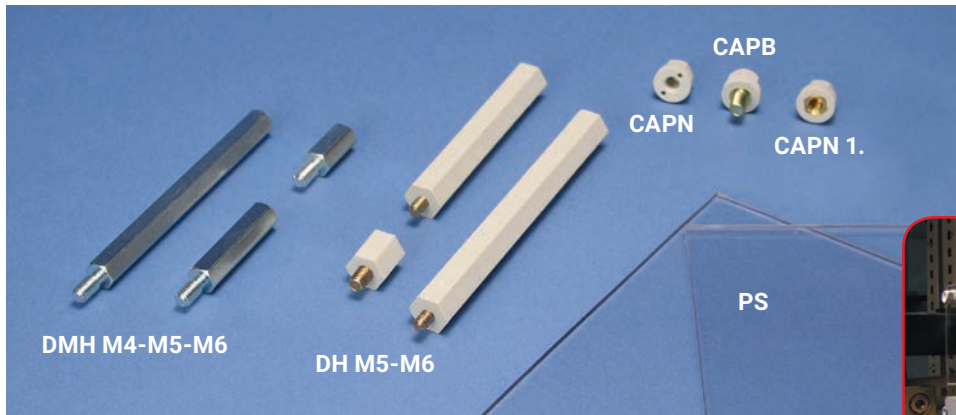

• A complete range of accessories for easy distribution block assembly

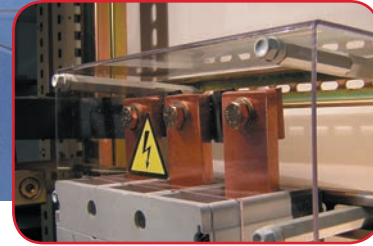

## DMH M4/M5/M6

### Metallic spacers

- Metallic hexagonal spacers
- Zinc-plated steel
- To make higher plates, screens or profiles
- Male-female allowing stable mounting
- See drawing on DH

Part No.	Description	L mm	Ø mm	A mm	B mm	Box	Bag
561560	DMH 10M4	10	M4	8-10	7	100	0,003
561570	DMH 15M4	15	M4	8-10	7	100	0,005
561580	DMH 20M4	20	M4	8-10	7	100	0,007
561590	DMH 25M4	25	M4	8-10	7	50	0,008
561600	DMH 30M4	30	M4	8-10	7	50	0,010
561610	DMH 35M4	35	M4	8-10	7	50	0,012
561620	DMH 40M4	40	M4	8-10	7	50	0,0125
561630	DMH 50M4	50	M4	8-10	7	50	0,017
561640	DMH 60M4	60	M4	8-10	7	25	0,019

561660	DMH 15M5	15	M5	10	8	50	0,006
561670	DMH 20M5	20	M5	10	8	50	0,008
561680	DMH 25M5	25	M5	10	8	50	0,010
561690	DMH 30M5	30	M5	10	8	50	0,012
561700	DMH 35M5	35	M5	10	8	25	0,014
561710	DMH 40M5	40	M5	10	8	25	0,016
561720	DMH 50M5	50	M5	10	8	25	0,022
561730	DMH 60M5	60	M5	10	8	25	0,027
561740	DMH 70M5	70	M5	10	8	25	0,029
561750	DMH 80M5	80	M5	10	8	25	0,033

561760	DMH 15M6	15	M6	10	10	50	0,010
561770	DMH 20M6	20	M6	12	10	50	0,012
561780	DMH 30M6	30	M6	12	10	25	0,018
561790	DMH 40M6	40	M6	12	10	25	0,025
561800	DMH 50M6	50	M6	12	10	25	0,032
561810	DMH 60M6	60	M6	12	10	25	0,038
561820	DMH 70M6	70	M6	12	10	25	0,043
561830	DMH 80M6	80	M6	12	10	25	0,052
561840	DMH 90M6	90	M6	12	10	25	0,058
561850	DMH 100M6	100	M6	12	10	10	0,064

## DH M5/M6

### Spacers

- Male-female
- Electrotechnical applications
- Insulating part made from polystyrol
- Threaded-end, made from zinc-plated steel
- Working temperature up to 80°C
- Insulation voltage 1000 V

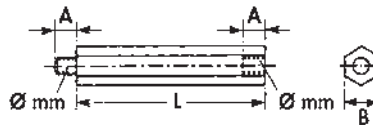

Part No.	Description	L mm	Ø mm	A mm	B mm	Box	Bag
560660	DH 15M5	15	M5	7	13	100	0,004
560670	DH 20M5	20	M5	7	13	100	0,005
560600	DH 30M5	30	M5	7	13	100	0,006
560610	DH 45M5	45	M5	7	13	100	0,009
560620	DH 55M5	55	M5	7	13	100	0,011
560630	DH 70M5	70	M5	7	13	100	0,014
560640	DH 85M5	85	M5	7	13	100	0,017
560650	DH 120M5	120	M5	7	13	100	0,024

560740	DH 15M6	15	M6	7-8	13	100	0,004
560750	DH 20M6	20	M6	7-8	13	100	0,005
560700	DH 30M6	30	M6	7-8	13	100	0,009
560710	DH 45M6	45	M6	7-8	13	100	0,013
560720	DH 70M6	70	M6	7-8	13	100	0,020
560730	DH 120M6	120	M6	7-8	13	100	0,035

## CAPN-CAPB

### Cap nuts

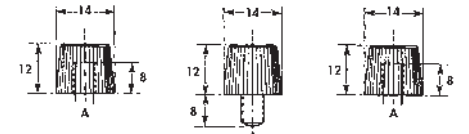

CAPN5 & CAPN6      CAPB5 & CAPB6      CAPN15 & CAPN16 with brass insert

Part No.	Description	A	Box	Bag
560800	CAPN5	M5	100	0,001
560810	CAPN6	M6	100	0,001
560820	CAPN15	M5	100	0,003
560830	CAPN16	M6	100	0,003
560840	CAPB5	M5	100	0,004
560850	CAPB6	M6	100	0,004

## PS

### Protection screen (made from PVC)

- $U_i = 1000 V$

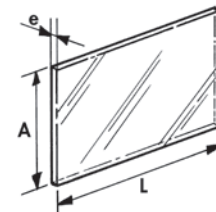

Part No.	Description	L mm	Ø mm	A mm	Mounts to	Box	Bag
563120	PS1000x60x3	1000	60	3	BSC 125A/S 10	0,302	
563130	PS500x120x3	500	120	3	BSC 125A/T 10	0,213	
551330	PS500x126x3	500	126	3	BS 125A/T 10	0,224	
551340	PS1000x99x3	1000	99	3	BS 125A/S 10	0,498	
551260	PS1000x250x3	1000	250	3	BS 400/T 1	1,030	
551280	PS1000x2000x3	1000	2000	3	-	1	8,4